



**WISWARE**

---

# Sms2Web

## User Manual

© 2010 Wisware Software Technologies Studio

Send comments about this document to: [support@wisware.com](mailto:support@wisware.com)

Copyright © 2010, Wisware Software Technologies Studio. All rights reserved.

This product or document is protected by copyright and distributed under licenses restricting its use, copying, distribution, and decompilation.

No part of this product or document may be reproduced in any form by any means without prior written authorization of Wisware Software Technologies Studio and its licensors, if any.

DOCUMENTATION IS PROVIDED "AS IS" AND ALL EXPRESS OR IMPLIED CONDITIONS, REPRESENTATIONS AND WARRANTIES, INCLUDING ANY IMPLIED WARRANTY OF MERCHANTABILITY, FITNESS FOR A PARTICULAR PURPOSE OR NON-INFRINGEMENT, ARE DISCLAIMED, EXCEPT TO THE EXTENT THAT SUCH DISCLAIMERS ARE HELD TO BE LEGALLY INVALID.



Please Recycle

# Content

<b>INTRODUCTION</b> .....	<b>1</b>
<b>ELEMENTS</b> .....	<b>2</b>
<b>WORK MODES</b> .....	<b>3</b>
<i>MMS mode</i> .....	<b>3</b>
<i>EMAIL mode</i> .....	<b>3</b>
<i>FTP mode</i> .....	<b>4</b>
<i>HTTP mode</i> .....	<b>4</b>
<b>SETTINGS GUIDE</b> .....	<b>6</b>
<b>SUPPORT</b> .....	<b>11</b>



# Chapter 1

## Introduction

**Sms2Web** is a bridge which connects short message (SMS) to Internet. With **Sms2Web** people are able to access short message anywhere through Internet. For web site owners, they can easily integrate sms functionality to their web sites with this application.

**Sms2Web** is application for Symbian S60 phones. This application can record all sms traffic in real time on its hosting phone, and transfer sms records to user desired target place. The target place can be email addresses, phone numbers, web sites or FTP servers.

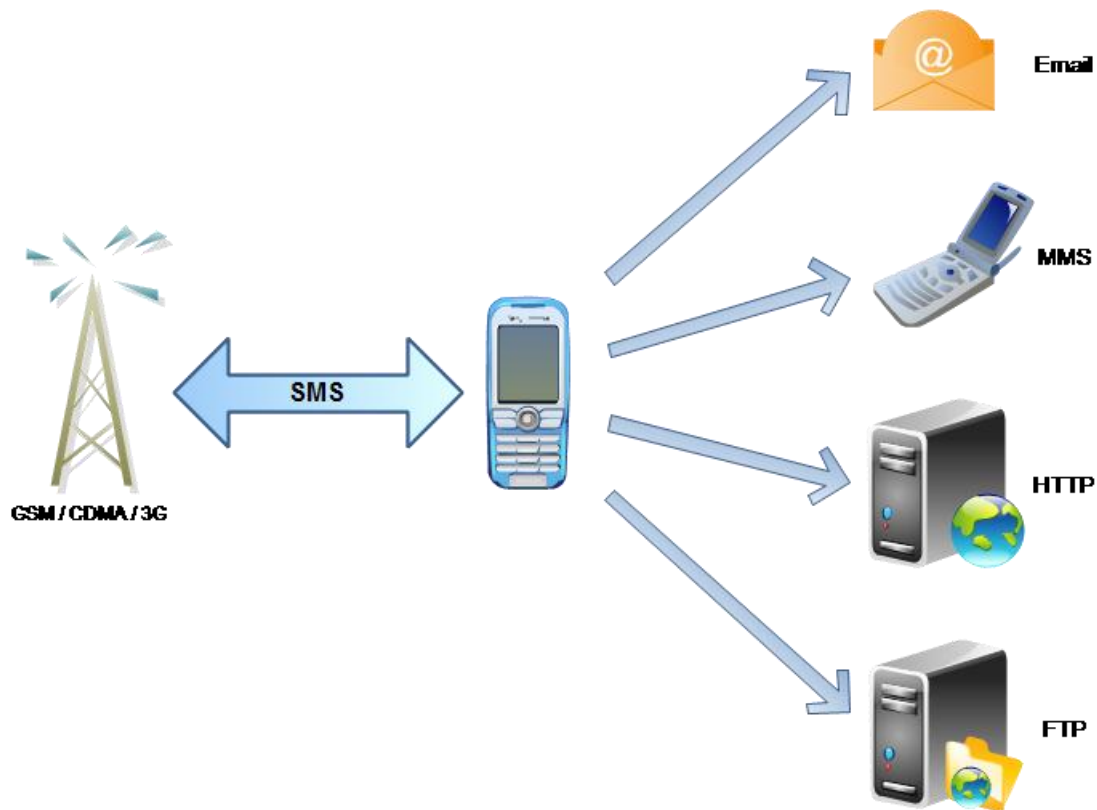

# Chapter 2

## Elements

**Sms2Web** supports several SMS elements. Sms log consists of these elements. Table 2.1 is the list of all elements.

Table 2.1

<i><b>Element</b></i>	<i><b>Description</b></i>	<i><b>Example</b></i>
<b>Phone number</b>	Phone number of sms sender.	+4498903476
<b>Name</b>	Name of sms sender. Name is searched by phone number in the contact book of application hosting phone.	Smith J
<b>Timestamp</b>	Time of sms being received/sent.	28/07/2009 15:15
<b>Direction</b>	Indicate a sms is incoming or outgoing.	outgoing
<b>Content</b>	The text content of sms.	The meeting will start at 10am.
<b>IMSI</b>	<b>IMSI</b> ( <i>International Mobile Subscriber Identity</i> ) is a unique number stored in the SIM. <b>Sms2Web</b> can transfer IMSI of its hosting phone. This element is not associated to sms but to the application hosting phone. If you have many phones transfer sms to the same place, you can tell which log is from which phone by IMSI element.	460000045156456



## Work Modes

**Sms2Web** has 4 work modes: **MMS** mode, **EMAIL** mode, **HTTP** mode and **FTP** mode. At a time only one mode can be activated. Select the mode per your needs and configure corresponding parameters in application settings.

### *MMS mode*

In MMS mode the application sends sms log to MMS addresses. You need to setup target MMS address. MMS address can be phone numbers or email addresses\*. You can set multiple MMS addresses, using “,” as separator between each MMS address.

Below is what sms log looks like in MMS mode.

```
[28/07/2009 15:15] [+4498903476] [Smith J] [outgoing] [460000045156456]
The meeting will start at 10am.
```

Sms log is sent as MMS text attachment of a MMS message. All text is in UTF-8 encoding.

If a MMS message is failed to send for some reason, it will be sent again together with next MMS message when new sms traffic comes.

### *EMAIL mode*

In EMAIL mode the application sends sms log to email addresses. You need to assign an email account and setup target email address. You can set multiple target email addresses, using “,” as separator between each email address. You may also set a recipient name, which is used in email “To” field. Below is what sms log looks like in EMAIL mode.

```
[28/07/2009 15:15] [+4498903476] [Smith J] [outgoing] [460000045156456]
The meeting will start at 10am.
```

You must assign an email account to send email. The email account is configured in phone native Messaging application (S60 email client) or Mail for Exchange client.

In EMAIL mode you can set the application to sms log as text attachment or email body. In any case the text is in UTF-8 encoding. If your email client cannot decode email body correctly, you must set sms log to send as attachment.



If an email is failed to send for some reason, it will be sent again together with next email when new sms traffic comes.

### **FTP mode**

In FTP mode the application sends sms log to a FTP server. You need to setup target FTP URL, port number, login user name and password. FTP URL must start with "ftp://". For example, "ftp://www.abc.com/public\_html/sms2ftp/" is a ftp server at abc.com and the remote folder is "public\_html/sms2ftp". You must create the folder and grant write privilege to the FTP account. You also need to select an IAP to be used by the application to make FTP connection. The IAP can be WLAN, GPRS or 3G.

In FTP mode sms log is sent as text file. **Sms2Web** generates filenames on the basis of sending time. For example, filename "sms2ftp\_20090725194203969000.txt" means the file is sent at 19:42: 03969 Jul/25/2009. All text in the file is in UTF-8 encoding. Below is what sms log looks like in FTP mode.

**[28/07/2009 15:15] [+4498903476] [Smith J] [outgoing] [46000045156456]**  
**The meeting will start at 10am.**

If the application failed to send sms log to FTP server, it will retry upon your selected timeouts or any new sms traffic, which comes first.

### **HTTP mode**

In HTTP mode the application sends sms log to a web server. You need to setup target HTTP URL. HTTP URL must start with "http://" or "https://". If your web server requires authentication, you need to set authentication username and password. **Sms2Web** supports basic authentication. You also need to select an IAP to be used by the application to make HTTP connection. The IAP can be WLAN, GPRS or 3G.

In HTTP mode the application sends sms log through HTTP request via POST method, just like post a form. Your HTTP URL (normally a script) should be able to handle the HTTP request. Available value names in the HTTP request are **number**, **name**, **direction**, **time** and **content**. Refer to below demo PHP script and also its output. The demo script receives HTTP request from **Sms2Web** and then writes result to a text file on web server.

```
<?
  $myFile = "Sms2Http.txt";           // Set file name on web server.
  $fh = fopen( $myFile, 'a' );       // Open file for write.

  fwrite( $fh, "IMSI: " );
  $stringData = $_POST["imsi"]."\n"; // Get IMSI of working SIM.
  fwrite($fh, $stringData);

  fwrite( $fh, "Phone Number: " );
```



```

$stringData = $_POST["number"]."\n";           // Get phone number.
fwrite($fh, $stringData);

fwrite( $fh, "Name: " );
$stringData = $_POST["name"]."\n";           // Get sender/receiver name.
fwrite($fh, $stringData);

fwrite( $fh, "Time: " );
$stringData = $_POST["time"]."\n";           // Get time string.
fwrite($fh, $stringData);

fwrite( $fh, "Direction: " );
$stringData = $_POST["direction"]."\n";       // Get sms direction (incoming/outgoing).
fwrite($fh, $stringData);

fwrite( $fh, "SMS Content: " );
$stringData = $_POST["content"]."\n";         // Get sms content.
fwrite($fh, $stringData);

fclose($fh);                                   // Close file.
?>

```

Output (Sms2Http.txt):

```

IMSI: 460000045156456
Phone Number: +4498903476
Name: Smith J
Time: 28/07/2009 15:15
Direction: outgoing
SMS Content: The meeting will start at 10am.

```

Any web developer is able to write such script. With **Sms2Web** and the script, web site owners can easily integrate SMS to their web sites.

If the application failed to communicate to HTTP URL, it will retry upon your selected timeouts or any new sms traffic, which comes first.



# Chapter 4

## Settings Guide

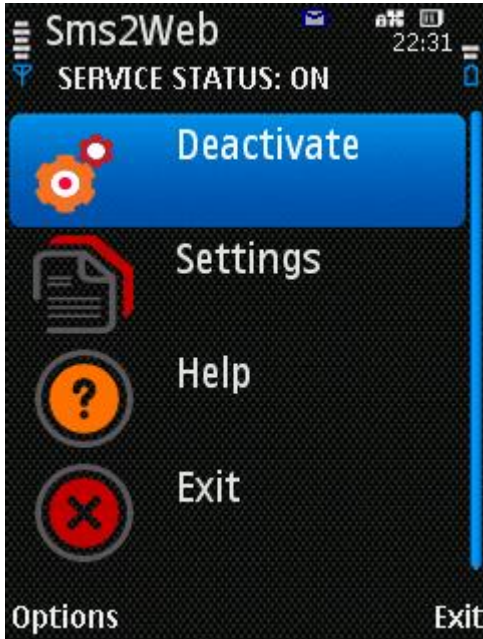

Open **Sms2Web**, you will see the console of the software.

- Click “**Activate**” / “**Deactivate**” to start / stop sms2web service.
- Click “**Settings**” to set configuration.
- Click “**Help**” to get context sensitive help.
- Click “**Exit**” to quit application console. **Close console does not affect sms2web service status.**



- **Auto start** – Start Sms2Web automatically upon phone is powered on.

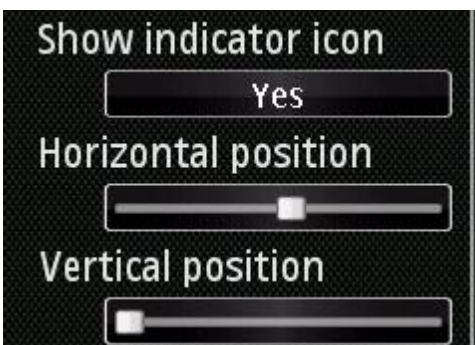

- **Show indicator icon** – Display a small icon at top of phone screen, which indicates Sms2Web service status.

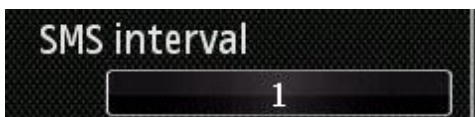

- **Horizontal position** – Set the horizontal position of indicator icon.
- **Vertical position** – Set the vertical position of indicator icon.
- **Sms interval** – Amount of sms to transfer each time. Sms2Web starts to send sms log once amount of sms in log reach this interval. In HTTP work mode, the interval must be 1, which means for each sms the application transfers a log to HTTP web server.





- **Record incoming sms** – Record incoming sms.
- **Delete incoming sms** - Delete incoming sms after record automatically.
- **Record outgoing sms** – Record outgoing sms.
- **Delete outgoing sms** - Delete outgoing sms after record automatically.

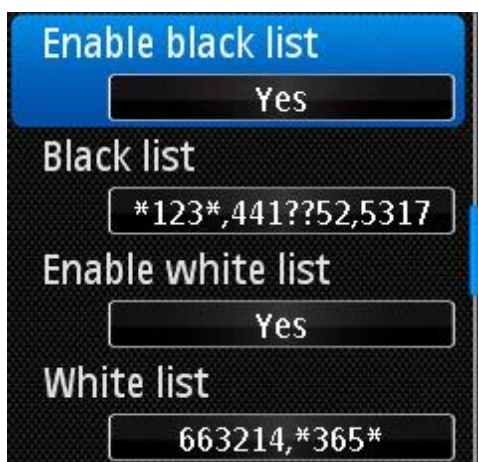

- **Enable black list** - When black list is enabled, SMS come from phone number in black list is NOT recorded.
- **Black list** - Set phone number of black list. Put "," as separator between phone numbers.
- **Enable white list** – When white list is enabled, only SMS come from phone number in white list is recorded.
- **White list** - Set phone number of white list. Put "," as separator between phone numbers.



- **Start time** - Time to start record. Start time must be earlier than stop time. If start time is not earlier than stop time, Sms2Web will always record sms.
- **Stop time** - Time to stop record. Start time must be earlier than stop time. If start time is not earlier than stop time, Sms2Web will always record sms.



- **Login password** - Set a password to access Sms2Web console. The password is up to 8 characters.





- **Phone number options** - Set how the application transfers the phone number of sms sender. You have 4 options.
  - Do not show
  - Show in title (MMS/EMAIL mode)
  - Show in body (MMS/EMAIL mode)
  - Show in title and body (MMS/EMAIL mode)

In FTP and HTTP modes, or **Sms interval** is more than 1, you can only set the application to transfer or NOT transfer phone number.

- **Name options** - Set how the application transfers the name of sms sender. *(Refer to Phone number options)*
- **Direction options** - Set how the application transfers the direction of sms. *(Refer to Phone number options)*
- **Timestamp options** - Set how the application transfers the timestamp of sms. *(Refer to Phone number options)*

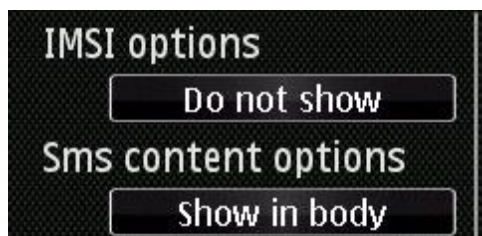

- **IMSI options** - Set how the application transfers the IMSI of hosting phone. *(Refer to Phone number options)*
- **Sms content options** - Set how the application transfers the text content of sms. If you choose to show content in title, only first 20 characters are transferred. *(Refer to Phone number options)*

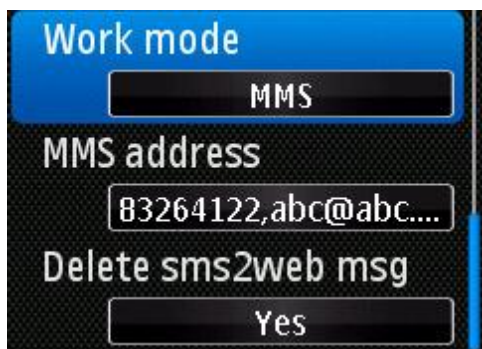

- **Work mode** - Set work mode. This feature determines how the application sends out sms log. 4 options are available: MMS, EMAIL, FTP and HTTP.
- **MMS address** - Set target MMS address to receive sms log. This feature is available in MMS mode. Put "," as separator between each MMS address.
- **Delete sms2web msg** - Delete the messages sent by **Sms2Web** in MMS and EMAIL modes. In EMAIL mode, this feature takes effect to S60 native email client and Mail for Exchange client.



**Email account**  
Wireless Labs

**Target email address**  
mail@abc.com

**Recipient name**  
ABC

**Send as attachment**  
Yes

- **Email account** – Assign an email account to be used to send sms log. This feature is available in EMAIL mode.
- **Target email address** – Set target email address to receive sms log. This feature is available in EMAIL mode. Put "," as separator between each email address.
- **Recipient name** – Set a recipient name. The name is used in email "To" field. This feature is available in EMAIL mode.
- **Send as attachment** – Send sms log as email text file attachment. All text is in UTF-8 encoding. Turn off this feature if you want to send log as email body, but it might cause character decoding problem for some languages. This feature is available in EMAIL mode.

**FTP URL**  
ftp://abc.com/publi...

**FTP username**  
test

**FTP password**  
\*\*\*\*\*

**FTP port**  
21

- **FTP URL** – Set the URL of FTP server. The URL must start with "ftp://". For example, "ftp://ABC.com/public\_html/sms/" is a ftp server at ABC.com and the remote path is "public\_html/sms". This feature is available in FTP mode.
- **FTP username** – Set FTP server login username. This feature is available in FTP mode.
- **FTP password** – Set FTP server login password. This feature is available in FTP mode.
- **FTP port** – Set FTP server port. This feature is available in FTP mode.

**HTTP URL**  
http://www.abc.com

**HTTP Authentication**  
basic

**HTTP Username**  
test

**HTTP Password**  
\*\*\*\*\*

- **HTTP URL** – Set the URL of HTTP server. The URL must start with "http://" or "https://". For example, "http://ABC.com/sms/". This feature is available in HTTP mode.
- **HTTP Authentication** – Set HTTP authentication to be used. 2 options are available: none and basic. This feature is available in HTTP mode.
- **HTTP username** – Set HTTP authentication username. This feature is available in HTTP mode.
- **HTTP password** – Set HTTP authentication password. This feature is available in HTTP mode.





- **Internet access point** – Select the IAP (Internet access point) to be used for FTP or HTTP connection. This feature is available in FTP mode and HTTP mode.



- **Retry interval** – Set time interval in minutes for retry upon communication fail. This feature is available in FTP mode and HTTP mode.



# Chapter 5

## Support

If you have any questions or suggestions, please contact us:

Web site: <http://www.wisware.com>  
Email: [support@wisware.com](mailto:support@wisware.com)

